

13 St. Catherines Terrace

Hove, BN3 2RH

Asking price £295,000



- Stunning sea views
- Walking distance to beach
- Period features
- Modern bathroom
- Costal lifestyle
- Bright living room
- Bay fronted window
- Separate kitchen
- Fantastic location
- Chain Free

Energy Efficiency Rating		
	Current	Potential
Very energy efficient - lower running costs		
(92 plus) A		
(81-91) B		
(69-80) C		
(55-68) D		
(39-54) E		
(21-38) F		
(1-20) G		
Not energy efficient - higher running costs		
		79
	39	
EU Directive 2002/91/EC		
England & Wales		

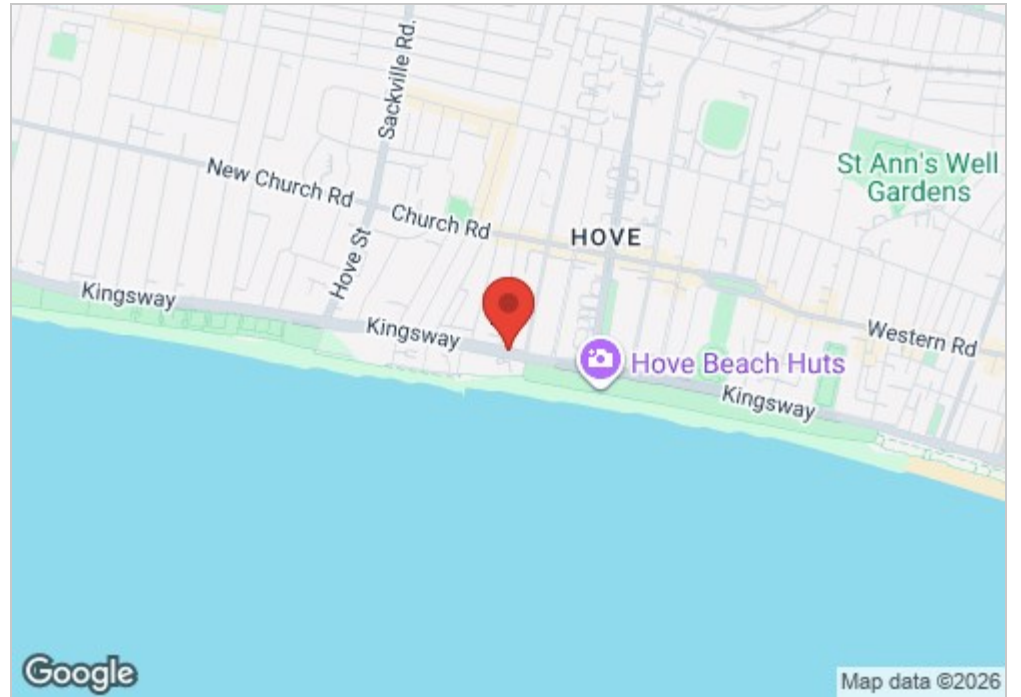

ST CATHERINE'S TERRACE

Approx. Gross Internal Floor Area = 51.56 sq m / 554.98 sq ft
 Illustration for identification purposes only, measurements are approximate, not to scale.

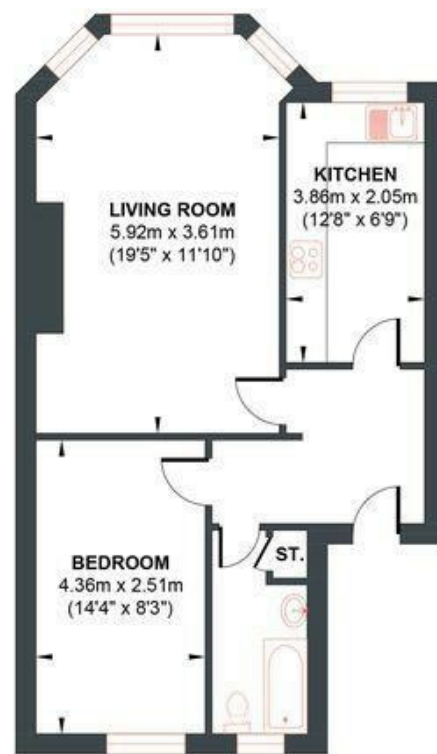

GROUND FLOOR

Approximate Floor Area
 554.98 sq ft
 (51.56 sq m)



Foster & Co and their clients give notice that:
 These sales particulars do not constitute any part of an offer of contract and are for guidance for prospective purchases only and should be not relied upon as a statement of fact.
 We are not to be held responsible for material information that has not been given to us by our client at the time of marketing.
 All measurements are approximate

